



**Power clamp compact
body total protection
integrated sensing
side mounting central
arm**

Maximum air pressure 8
BAR. Normal working 5
BAR

Dry air is permissible
Restrictors must be used in
conjunction with cylinder

Torque 85Nm at 5BAR
Weight 2.3kg

Arm options

- CA Center arm
- CAR Center arm right
- CAL Center arm left

Sensing options

- NS No Sensing
- MC Magnetic Cylinder
(for magnetic switch)
- ES3 Inductive Switches
(1 outlet)

Opening Angles

- 30°, 45°, 90°, 105°
- See order guide for further
information

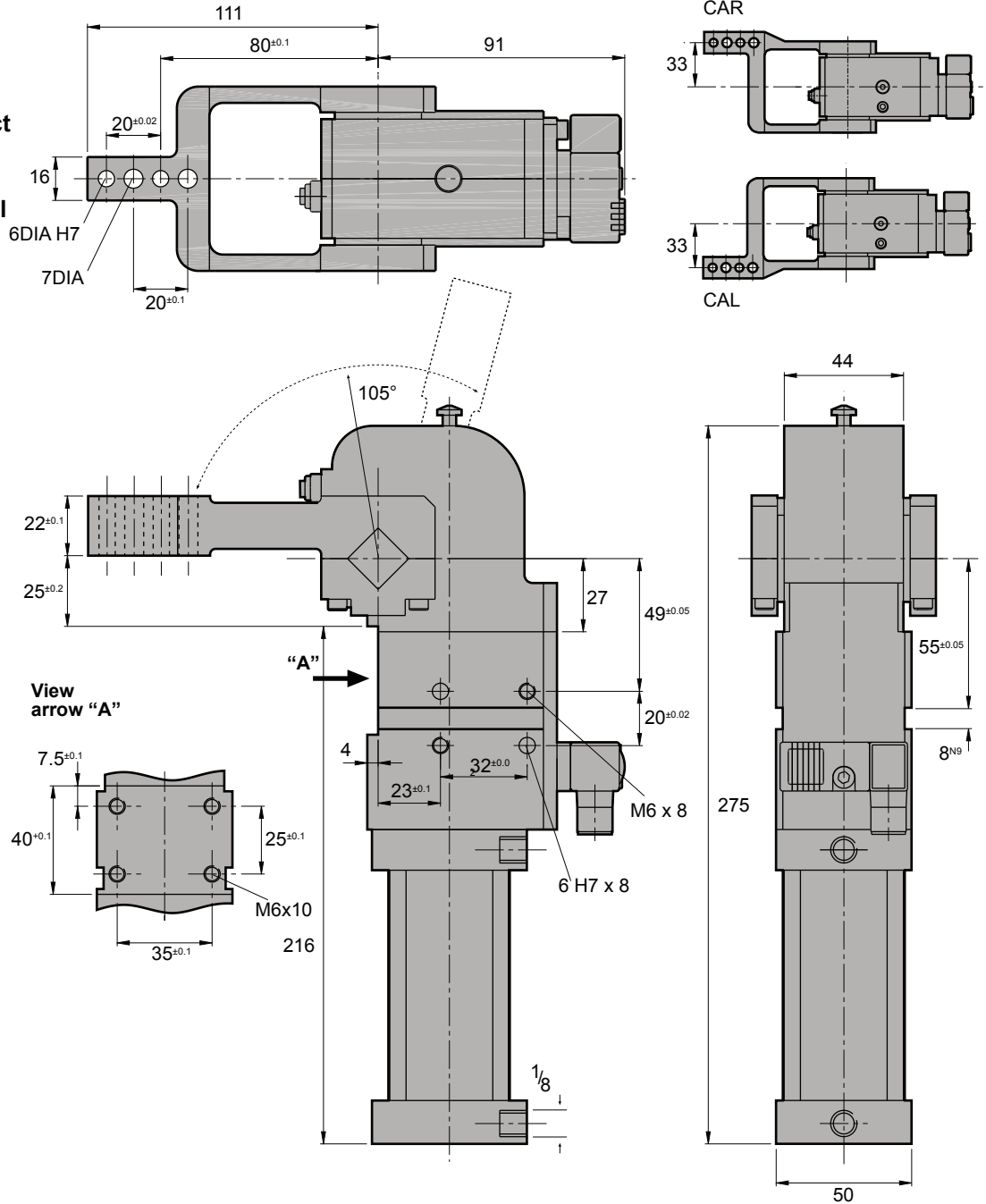

XSM240

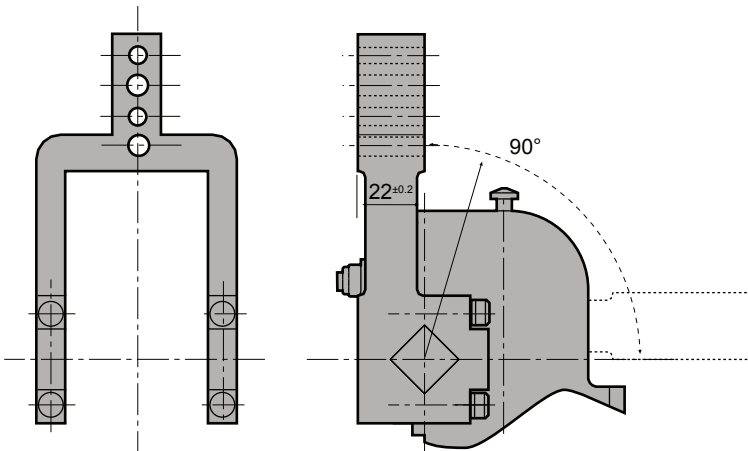

Auto Clamps 40 Bore

Order code guide for XSM25
& 40 power clamp products

example showing the break down of the order code:

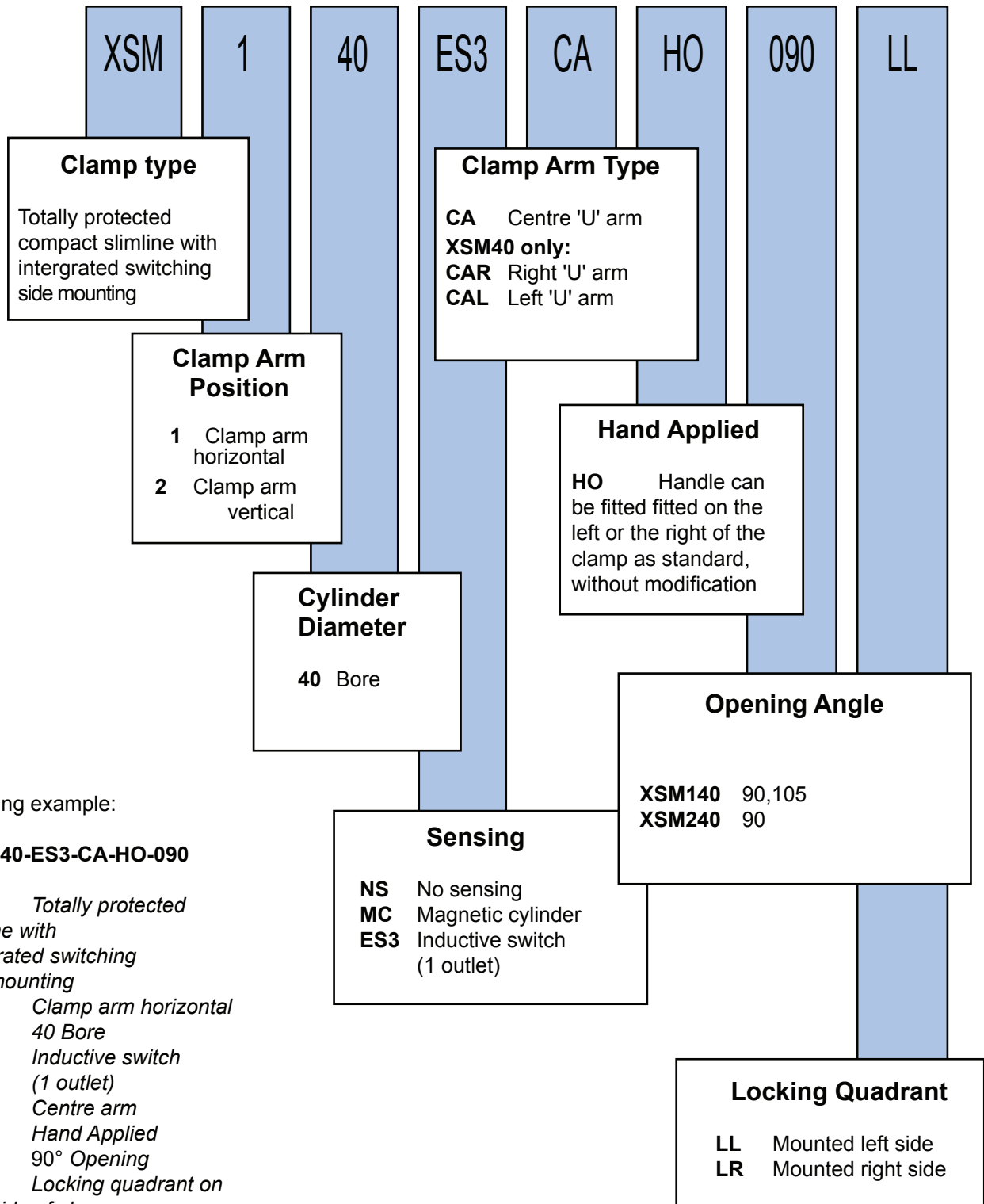

Ordering example:

XSM140-ES3-CA-HO-090

XSM Totally protected slimline with intergrated switching side mounting
1 Clamp arm horizontal
40 40 Bore
ES3 Inductive switch (1 outlet)
CA Centre arm
HO Hand Applied
090 90° Opening
LR Locking quadrant on right side of clamp